

**PUBLIC WORKS DEPARTMENT
MEMORANDUM # 2016 – 16**

DATE: March 7, 2016
TO: Honorable Mayor Joyce Downing and City Council Members
FROM: David H. Willett, Acting City Manager/Public Works Director
SUBJECT: Grant Street Improvements Update



BACKGROUND

As part of the Webster Lake Redevelopment area, including the new SCL hospital site, it was determined through engineering studies that modifications to the roadway corridor should occur to support the overall development of the area. The reconstruction of the roadway section will include construction of raised medians with landscaping, concrete curb and gutter, sidewalk replacement, milling and pavement overlay, striping and signage improvements. In addition, a signalized intersection has been installed under separate contract with NURA.

On February 10, 2016 the Northglenn Urban Renewal Authority (NURA) entered into a contract with Perfect Patch Asphalt Co. The total contract amount for the work is \$1,179,658.60. The tentative schedule for work to start is mid to end of March with a substantial completion of July 1. The contractor and staff will be working closely with the developer of the SCL hospital site to ensure work is completed in timely manner. In addition, the contractor, consultant and staff will work closely with the businesses within the Webster Lake Promenade to minimize the construction impacts from the project.

STAFF REFERENCE

Kent Kisselman, PE, Engineering Manager
Gregory Yanker, PE, Lead Engineer

kkisselman@northglenn.org 303.450.4005
gyanker@northglenn.org 303.450.8780

ATTACHMENTS

- Bid Summary
- Plans



CITY OF NORTHGLENN
FORMAL BID SUMMARY

BID NUMBER: IFB - 2015-031

BID NAME: Grant Street Improvements

DEPARTMENT: NURA

	Noraa Concrete Construction Corp.	The Perfect Patch Asphalt Co., Inc.	Concrete Express, Inc.		
	BID RECEIVED	BID RECEIVED	BID RECEIVED	BID RECEIVED	BID RECEIVED
DATE DUE: 01/28/16	DATE: 1/28/16	DATE: 1/28/16	DATE: 1/28/16	DATE:	DATE:
TIME: 2:00 p.m. MST	TIME: 12:19pm	TIME: 12:30pm	TIME: 1:31pm	TIME:	TIME:
Addendum	Yes	Yes	Yes		
Grand Total	\$1,374,095.20	\$1,179,658.60	\$1,298,089.70		

FINANCE DEPARTMENT

CITY CLERK'S OFFICE

January 28, 2016
DATE

NORTHGLENN URBAN RENEWAL AUTHORITY

Grant Street Improvements

LOCATED IN
TOWNSHIP 2 SOUTH, RANGE 68 WEST, 6th P.M.
COUNTY of ADAMS, STATE of COLORADO
DECEMBER, 2015

EXHIBIT A

ISSUED FOR BID



305 Denver Avenue - Suite D
 Fort Lupton, CO 80621
 Ph: 303-857-6222 Fax: 303-857-6224
 www.jtconsulting.com

Grant Street Improvements

Cover Sheet

Northglenn Urban Renewal Authority

REVISIONS

No.	Date	By	Chk	Description
1	11.5.15	WSS	JCY	NURA Comments
2	12.7.15	CMS	JCY	Issued for Bid

Job #	15116
Date	8/14/15
Drawn By	WSS
Designed By	TFY
Checked By	JCY
File	JT-NURA Cover
Scale	As Shown

Sheet: **1** of **22**

LEGEND

--- 5290 ---	EXISTING CONTOURS
=====	EXISTING EDGE OF CONCRETE
-----G-----	EXISTING GAS LINE
-----W-----	EXISTING WATERLINE
-----SAN-----	EXISTING SEWER LINE
-----ST-----	EXISTING STORM SEWER
-----CTV-----	EXISTING CABLE TV
-----E-----	EXISTING POWER
-----T-----	EXISTING TELEPHONE
-----	EXISTING ROW
-----	EXISTING EASEMENT
⊙	EXISTING SEWER MANHOLE
FO	EXISTING FIBER OPTIC
⊕	EXISTING FIRE HYDRANT
⊗	EXISTING WATER METER
⊗	EXISTING WATER VALVE
⊗	EXISTING STORM SEWER MANHOLE
⊗	EXISTING TREE
▭	CONCRETE

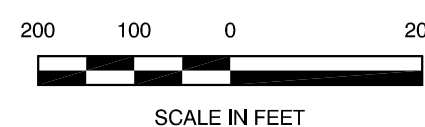

VICINITY MAP

SCALE 1" = 200'±



OWNER

Northglenn Urban Renewal Authority
 11701 Community Center Drive
 Northglenn, CO 80233
 303-451-8326

SURVEYOR

American West Land Surveying Co.
 331 South 4th Avenue
 P.O. Box 129
 Brighton, CO 80601
 303-659-1532

ENGINEER

J&T Consulting, Inc.
 J.C. York
 305 Denver Ave., Ste. D
 Fort Lupton, CO 80621
 303-857-6222
 Fax: 303-857-6224

BASIS OF BEARINGS:

BASIS OF BEARINGS: ALL BEARINGS ARE BASED UPON THE PLAT OF WEBSTER LAKE PROMINADE, RECORDED JULY 5, 2013 AS RECEPTION NO. 2013000057754 IN THE RECORDS OF THE CLERK AND RECORDER FOR ADAMS COUNTY, COLORADO, WITH A LINE BETWEEN CONTROL POINT NO. 592 AND CONTROL POINT NO. 434 HAVING A BEARING OF NORTH 37°40'42" EAST AS MONUMENTED HEREON WITH ALL BEARINGS RELATIVE THERETO.

BASIS OF ELEVATION: ALL ELEVATIONS SHOWN HEREON ARE BASED UPON STATIC GPS OBSERVATIONS POST PROCESSED THROUGH (DPOS) JAVAD DATA PROCESSING ONLINE SERVICE, RESULTING IN CONTROL POINT NO. 434 HAVING AN ELEVATION OF 5379.75 NAVD 88 (GEOID 12A).

PT #	NORTHING	EASTING	ELEVATION	DESCRIPTION
434	1758216.62	3145147.38	5379.75	NAIL & BRASS TAG IN SIDEWALK, PLS 6973.
592	1757941.83	3144935.16	5387.35	NAIL & BRASS TAG IN SIDEWALK, PLS 34995.
646	1758113.10	3145018.22	5381.74	1/2" REBAR FLUSH WITH ASPHALT.
651	1758107.70	3145045.74	5380.27	1/2" REBAR WITH GREEN PLASTIC CAP, FLUSH WITH ASPHALT.
989	1758156.97	3145147.12	5379.96	5/8" REBAR WITH YELLOW PLASTIC CAP, PLS 6973.
1329	1757497.09	3144569.80	5396.29	5/8" REBAR WITH YELLOW PLASTIC CAP, FLUSH WITH ASPHALT.
1423	1757742.02	3144684.67	5395.11	CITY OF NORTHGLENN BM NO. 15, 3 1/4" ALUMINUM CAP IN CONCRETE.
1491	1757815.06	3144745.85	5394.04	5/8" REBAR.
1512	1757837.97	3144776.65	5392.95	1/2" REBAR WITH GREEN PLASTIC CAP, PLS 34995.



SHEET INDEX

1	Cover Sheet
2	General Notes
3	Existing Conditions
4	Demolition Plan
5	Site Plan
6	Curb & Gutter Horizontal Control Plan
7	Curb & Gutter Vertical Control Plan
8-9	Roadway Spot Elevations
10	Signage & Striping Plan
11-12	Roadway Details & Cross-Sections
13-14	Erosion Control Plan & Details
15-22	Traffic Control Plan

Engineer's Certification

I hereby certify that these plans for the construction of the Northglenn Urban Renewal Authority Grant Street Improvements Project were prepared by me or under my direct supervision for the Northglenn Urban Renewal Authority.

James C. York, P.E.
 Colorado Registration No. 36846

No.	Date	By	Chk	Description
1	11.5.15	WSS	JCY	NURA Comments
2	12.7.15	CMS	JCY	Issued for Bid

Job #	15116
Date	8/14/15
Drawn By	WSS
Designed By	TPY
Checked By	JCY
File	JT-NURA signage

Scale: _____

Sheet: **10** Of: **22**

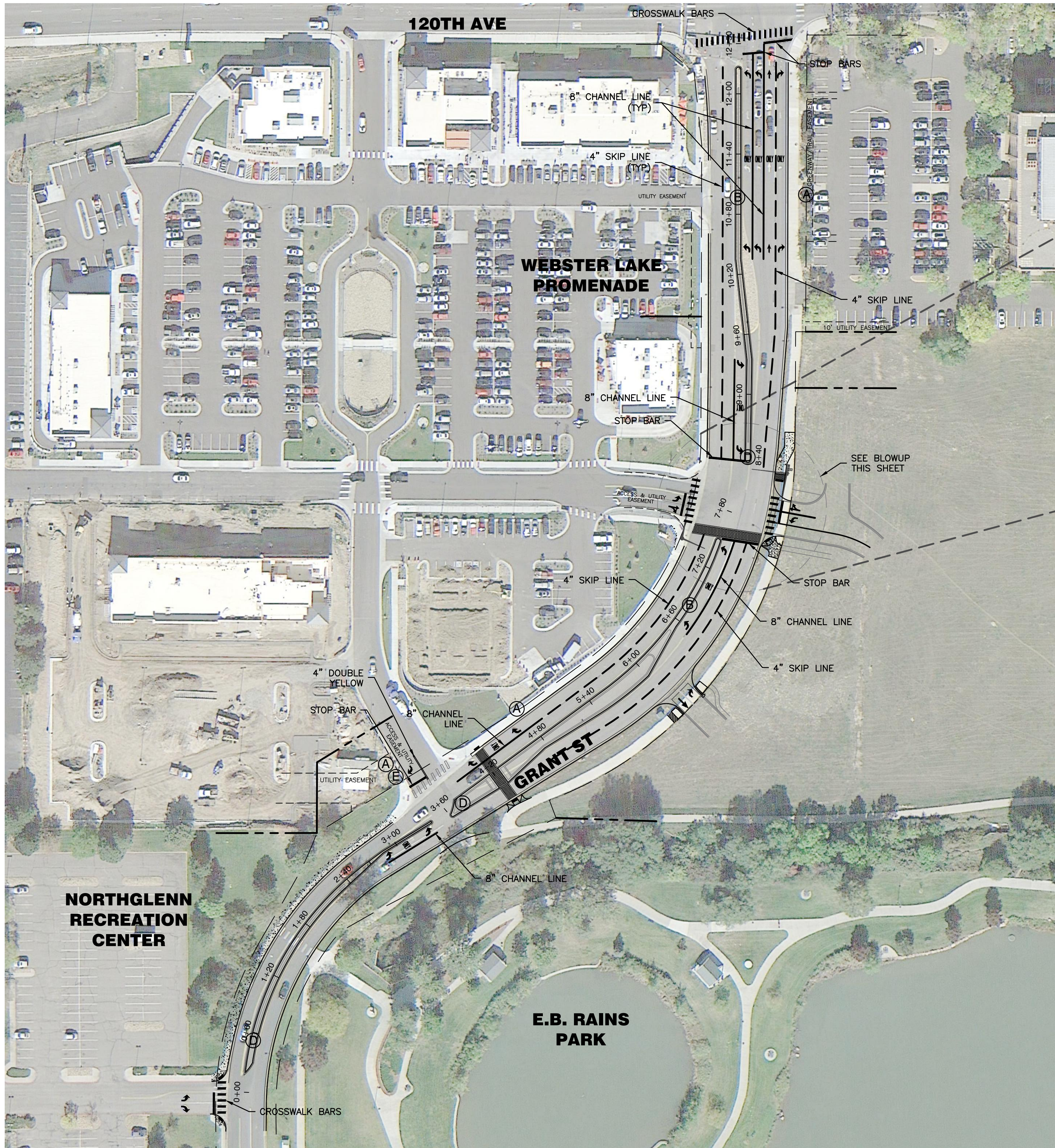

NOTES:

1. ALL STOP AND CROSS-WALK BAR MATERIALS AND INSTALLATION FOR THIS PROJECT SHALL CONFORM WITH PREFORMED THERMOPLASTIC MARKING CRITERIA SET FOR IN SECTION 713.14 OF THE CDOT STANDARD SPECIFICATIONS FOR ROAD AND BRIDGE CONSTRUCTION AND ANY APPLICABLE REVISIONS THERETO.
2. STOP BARS SHALL BE 24" WIDE, SHALL SPAN THE ENTIRE WIDTH OF THE APPROACHING LANE, AND SHALL BE ALIGNED WITH ALL STOP SIGNS IN ACCORDANCE WITH THE MANUAL ON UNIFORM TRAFFIC CONTROL DEVICES.
3. CROSS-WALK BARS SHALL BE 24" WIDE, SHALL BE 8' DEEP, SHALL HAVE A GAP OF 6' BETWEEN LINES, SHALL BE PLACED TO AVOID A MOTOR VEHICLE WHEEL PATH, SHALL SPAN THE ENTIRE WIDTH OF THE INTERSECTIONS, AND SHALL EXTEND FROM EACH OF THE MIDPOINTS OF THE HANDICAP RAMPS LOCATED AT INTERSECTIONS.
4. ALL MARKINGS SHALL BE HIGH INTENSITY GRADE SHEETING.

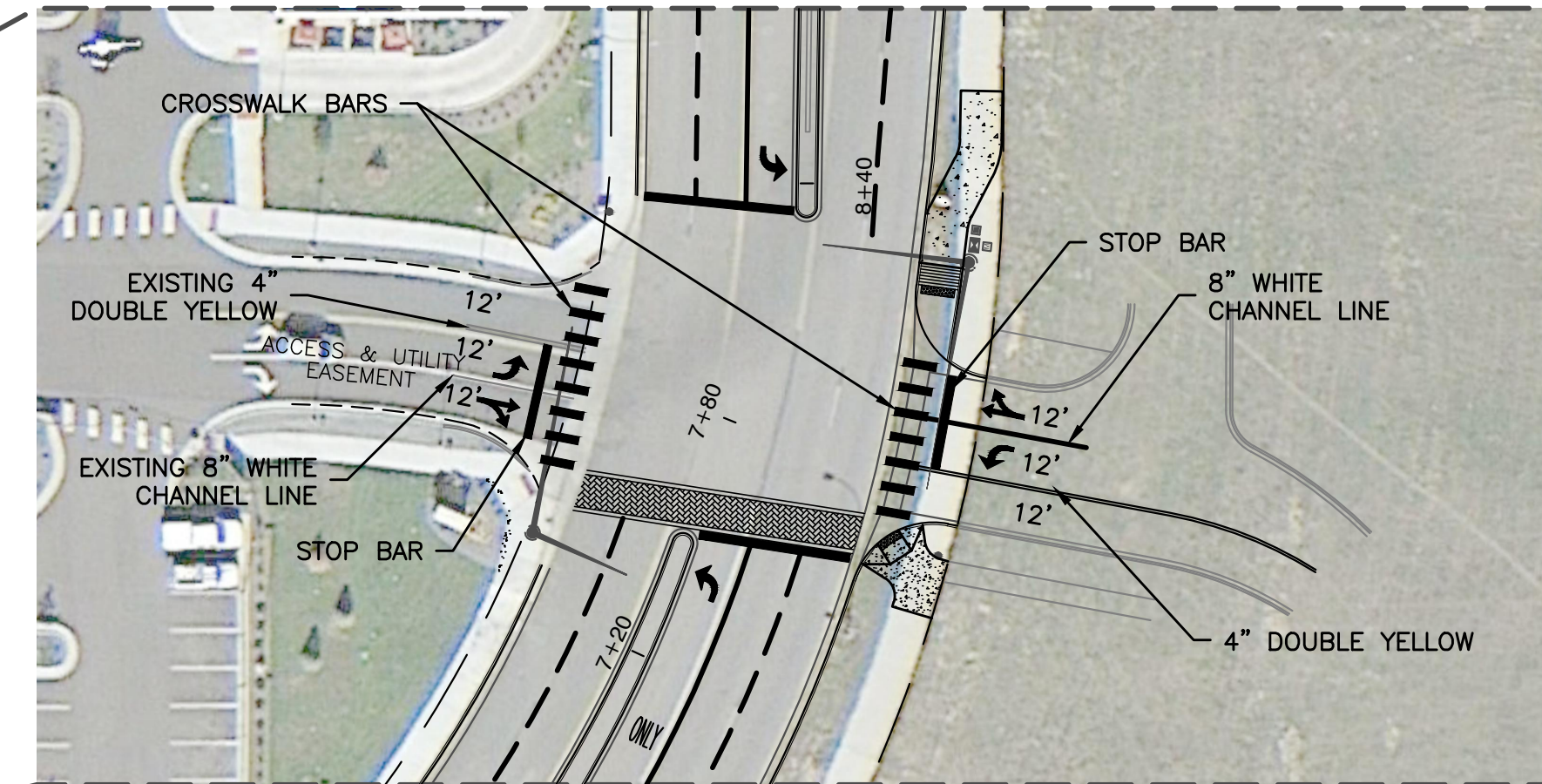

LEGEND		
KEY	DESCRIPTION	SIGN
A	R3-7R	
B	R3-7L	
C	R4-7A	
D	R4-7	
E	R3-2	

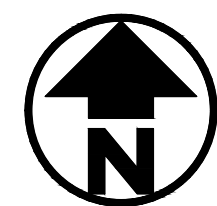

REUSE OF DOCUMENT
This document is the property of DHM Design Corp. The ideas and design incorporated on this document is an instrument of professional service and shall not be used for any other project without written authorization of DHM Design Corp.

GRANT STREET MEDIANS
Northglenn, Colorado

PROJECT NUMBER: 15262.00
DATE: 11-10-2015
DESIGNED: MTW
DRAWN: CTF
CHECKED: MTW

JOB DESCRIPTION:
CONSTRUCTION DRAWINGS

SHEET TITLE:
ENLARGEMENT PLAN

SCALE: 1"=10'-0"
SHEET NUMBER:
L1.2

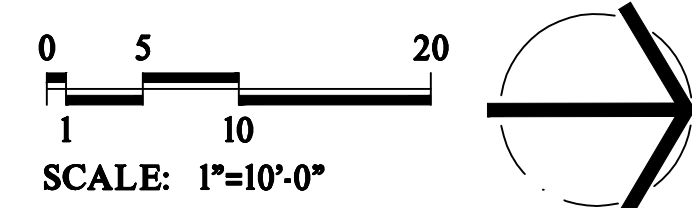
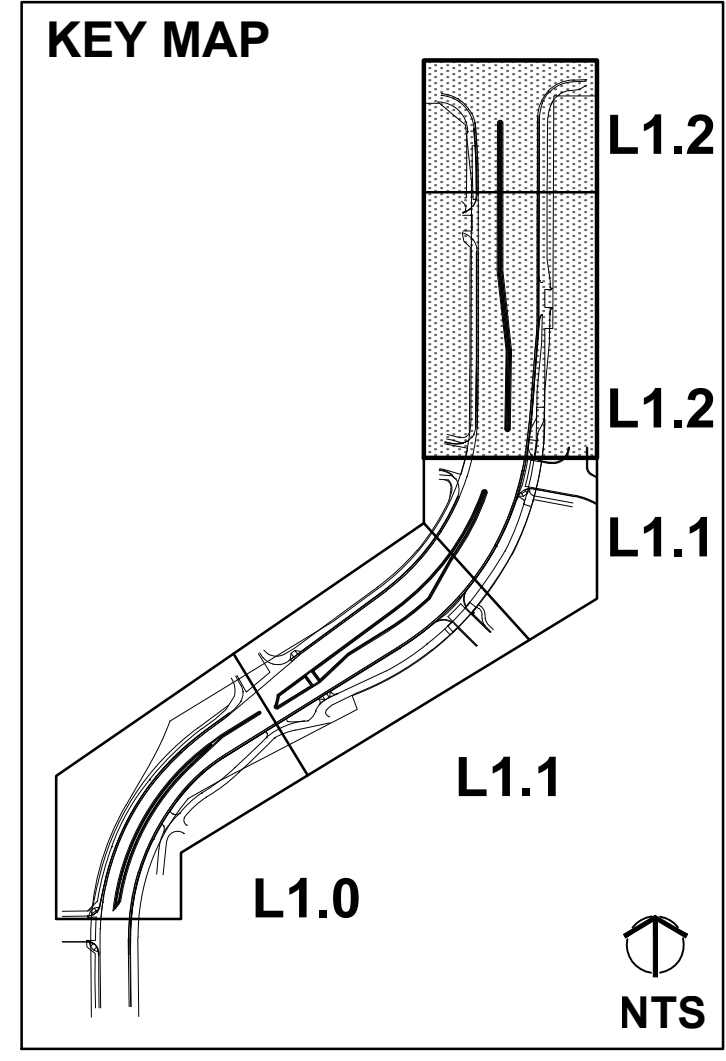
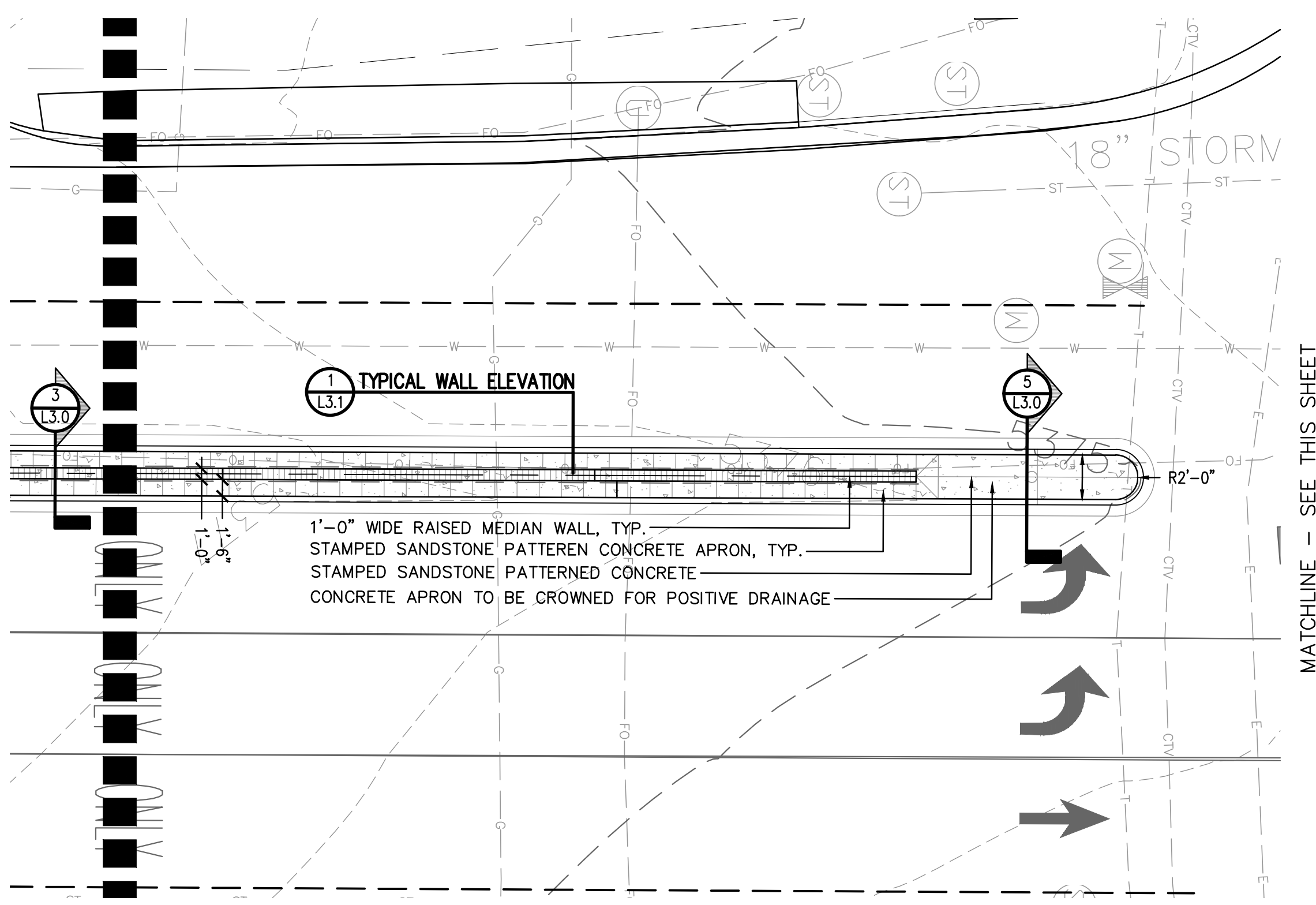
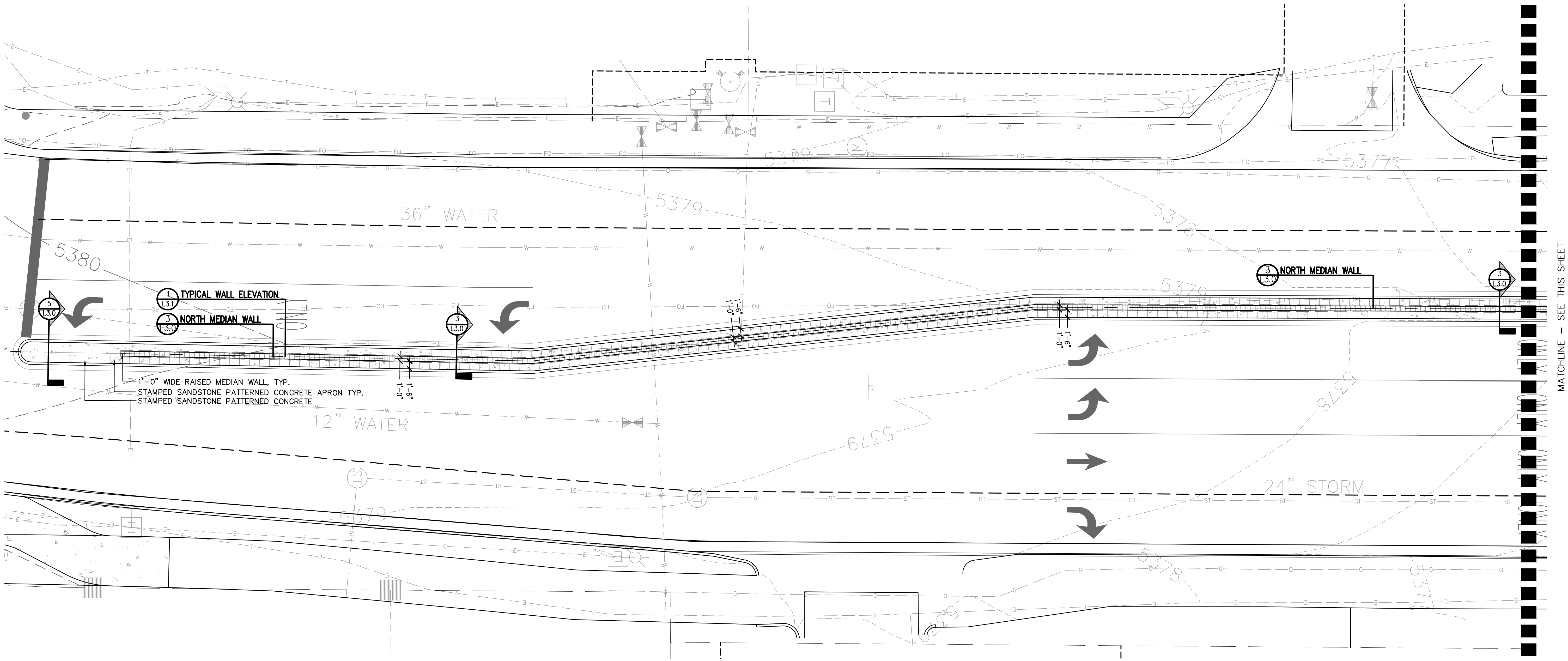

XREFS: ...
 FILE NAME: ...
 PLOT DATE: ...

REUSE OF DOCUMENT
This document is the property of DHM Design Corp. The ideas and design incorporated on this document is an instrument of professional service and shall not be used for any other project without written authorization of DHM Design Corp.

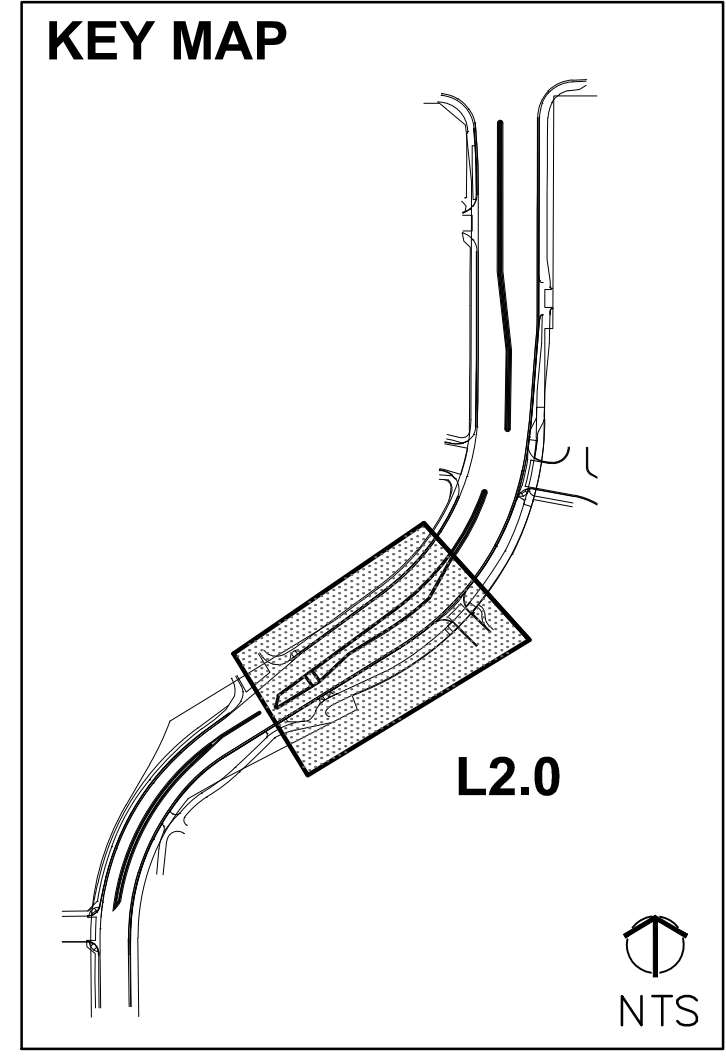
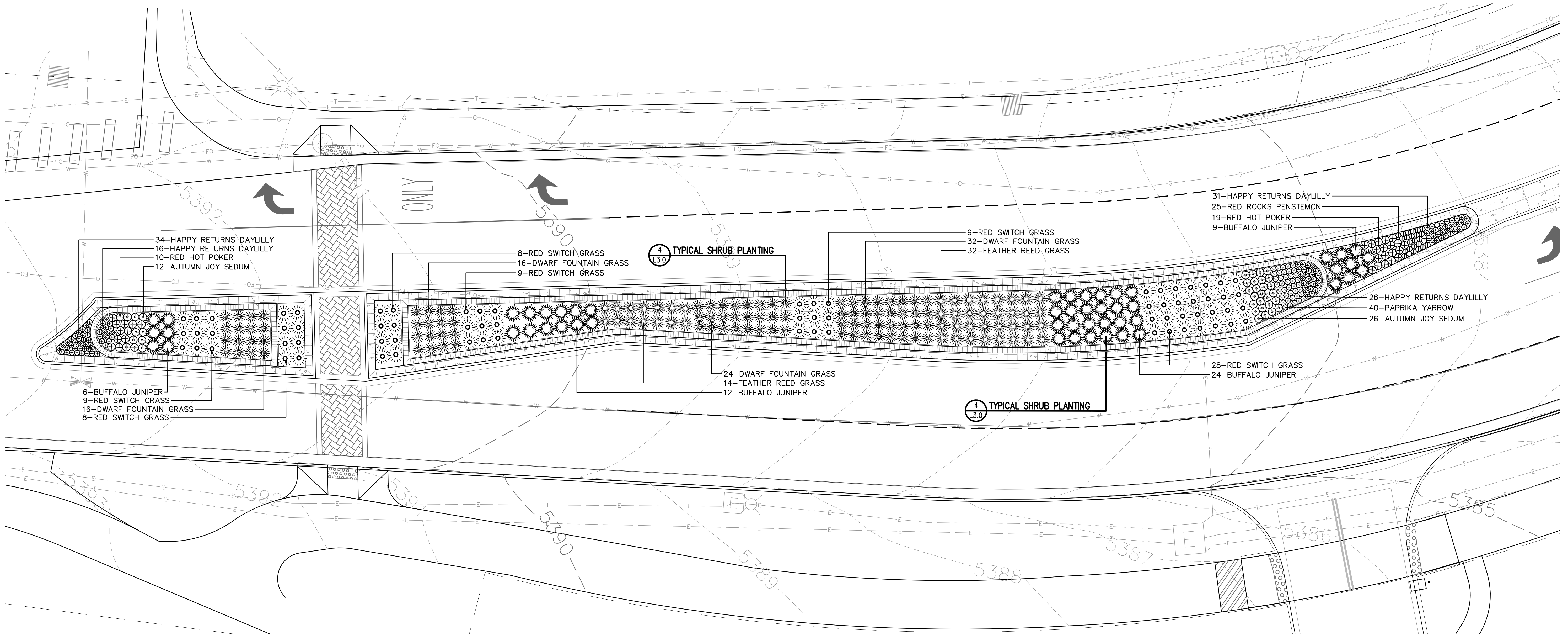

GRANT STREET MEDIANS
Northglenn, Colorado

PROJECT NUMBER: 15262.00 DATE: 11-10-2015

DESIGNED: MTW
DRAWN: CTF
CHECKED: MTW

REVISIONS:

JOB DESCRIPTION:
CONSTRUCTION
DRAWINGS

SHEET TITLE:
LANDSCAPE PLAN

SCALE: 1"=10'-0"

SHEET NUMBER:

L2.0

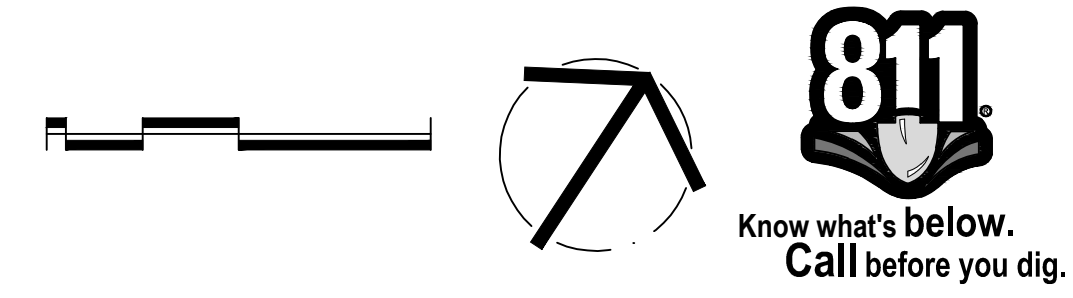

XREFS: 15262-00-01.dwg - 15262-00-01.dwg
 15262-00-02.dwg - 15262-00-02.dwg
 15262-00-03.dwg - 15262-00-03.dwg
 15262-00-04.dwg - 15262-00-04.dwg
 15262-00-05.dwg - 15262-00-05.dwg
 15262-00-06.dwg - 15262-00-06.dwg
 15262-00-07.dwg - 15262-00-07.dwg
 15262-00-08.dwg - 15262-00-08.dwg
 15262-00-09.dwg - 15262-00-09.dwg
 15262-00-10.dwg - 15262-00-10.dwg
 15262-00-11.dwg - 15262-00-11.dwg
 15262-00-12.dwg - 15262-00-12.dwg
 15262-00-13.dwg - 15262-00-13.dwg
 15262-00-14.dwg - 15262-00-14.dwg
 15262-00-15.dwg - 15262-00-15.dwg
 15262-00-16.dwg - 15262-00-16.dwg
 15262-00-17.dwg - 15262-00-17.dwg
 15262-00-18.dwg - 15262-00-18.dwg
 15262-00-19.dwg - 15262-00-19.dwg
 15262-00-20.dwg - 15262-00-20.dwg
 15262-00-21.dwg - 15262-00-21.dwg
 15262-00-22.dwg - 15262-00-22.dwg
 15262-00-23.dwg - 15262-00-23.dwg
 15262-00-24.dwg - 15262-00-24.dwg
 15262-00-25.dwg - 15262-00-25.dwg
 15262-00-26.dwg - 15262-00-26.dwg
 15262-00-27.dwg - 15262-00-27.dwg
 15262-00-28.dwg - 15262-00-28.dwg
 15262-00-29.dwg - 15262-00-29.dwg
 15262-00-30.dwg - 15262-00-30.dwg
 15262-00-31.dwg - 15262-00-31.dwg
 15262-00-32.dwg - 15262-00-32.dwg
 15262-00-33.dwg - 15262-00-33.dwg
 15262-00-34.dwg - 15262-00-34.dwg
 15262-00-35.dwg - 15262-00-35.dwg
 15262-00-36.dwg - 15262-00-36.dwg
 15262-00-37.dwg - 15262-00-37.dwg
 15262-00-38.dwg - 15262-00-38.dwg
 15262-00-39.dwg - 15262-00-39.dwg
 15262-00-40.dwg - 15262-00-40.dwg
 15262-00-41.dwg - 15262-00-41.dwg
 15262-00-42.dwg - 15262-00-42.dwg
 15262-00-43.dwg - 15262-00-43.dwg
 15262-00-44.dwg - 15262-00-44.dwg
 15262-00-45.dwg - 15262-00-45.dwg
 15262-00-46.dwg - 15262-00-46.dwg
 15262-00-47.dwg - 15262-00-47.dwg
 15262-00-48.dwg - 15262-00-48.dwg
 15262-00-49.dwg - 15262-00-49.dwg
 15262-00-50.dwg - 15262-00-50.dwg
 15262-00-51.dwg - 15262-00-51.dwg
 15262-00-52.dwg - 15262-00-52.dwg
 15262-00-53.dwg - 15262-00-53.dwg
 15262-00-54.dwg - 15262-00-54.dwg
 15262-00-55.dwg - 15262-00-55.dwg
 15262-00-56.dwg - 15262-00-56.dwg
 15262-00-57.dwg - 15262-00-57.dwg
 15262-00-58.dwg - 15262-00-58.dwg
 15262-00-59.dwg - 15262-00-59.dwg
 15262-00-60.dwg - 15262-00-60.dwg
 15262-00-61.dwg - 15262-00-61.dwg
 15262-00-62.dwg - 15262-00-62.dwg
 15262-00-63.dwg - 15262-00-63.dwg
 15262-00-64.dwg - 15262-00-64.dwg
 15262-00-65.dwg - 15262-00-65.dwg
 15262-00-66.dwg - 15262-00-66.dwg
 15262-00-67.dwg - 15262-00-67.dwg
 15262-00-68.dwg - 15262-00-68.dwg
 15262-00-69.dwg - 15262-00-69.dwg
 15262-00-70.dwg - 15262-00-70.dwg
 15262-00-71.dwg - 15262-00-71.dwg
 15262-00-72.dwg - 15262-00-72.dwg
 15262-00-73.dwg - 15262-00-73.dwg
 15262-00-74.dwg - 15262-00-74.dwg
 15262-00-75.dwg - 15262-00-75.dwg
 15262-00-76.dwg - 15262-00-76.dwg
 15262-00-77.dwg - 15262-00-77.dwg
 15262-00-78.dwg - 15262-00-78.dwg
 15262-00-79.dwg - 15262-00-79.dwg
 15262-00-80.dwg - 15262-00-80.dwg
 15262-00-81.dwg - 15262-00-81.dwg
 15262-00-82.dwg - 15262-00-82.dwg
 15262-00-83.dwg - 15262-00-83.dwg
 15262-00-84.dwg - 15262-00-84.dwg
 15262-00-85.dwg - 15262-00-85.dwg
 15262-00-86.dwg - 15262-00-86.dwg
 15262-00-87.dwg - 15262-00-87.dwg
 15262-00-88.dwg - 15262-00-88.dwg
 15262-00-89.dwg - 15262-00-89.dwg
 15262-00-90.dwg - 15262-00-90.dwg
 15262-00-91.dwg - 15262-00-91.dwg
 15262-00-92.dwg - 15262-00-92.dwg
 15262-00-93.dwg - 15262-00-93.dwg
 15262-00-94.dwg - 15262-00-94.dwg
 15262-00-95.dwg - 15262-00-95.dwg
 15262-00-96.dwg - 15262-00-96.dwg
 15262-00-97.dwg - 15262-00-97.dwg
 15262-00-98.dwg - 15262-00-98.dwg
 15262-00-99.dwg - 15262-00-99.dwg
 15262-00-100.dwg - 15262-00-100.dwg

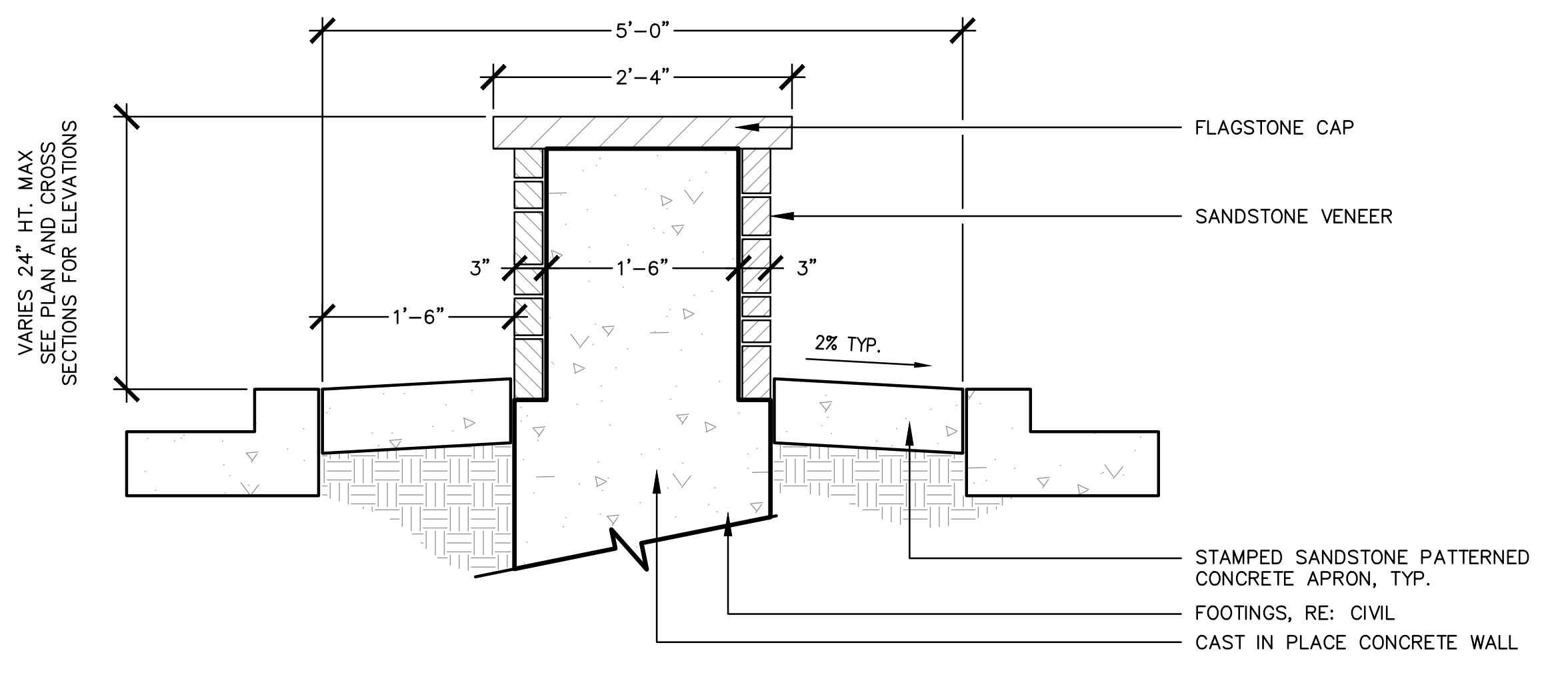

1 SOUTH MEDIAN WALL SCALE: NTS

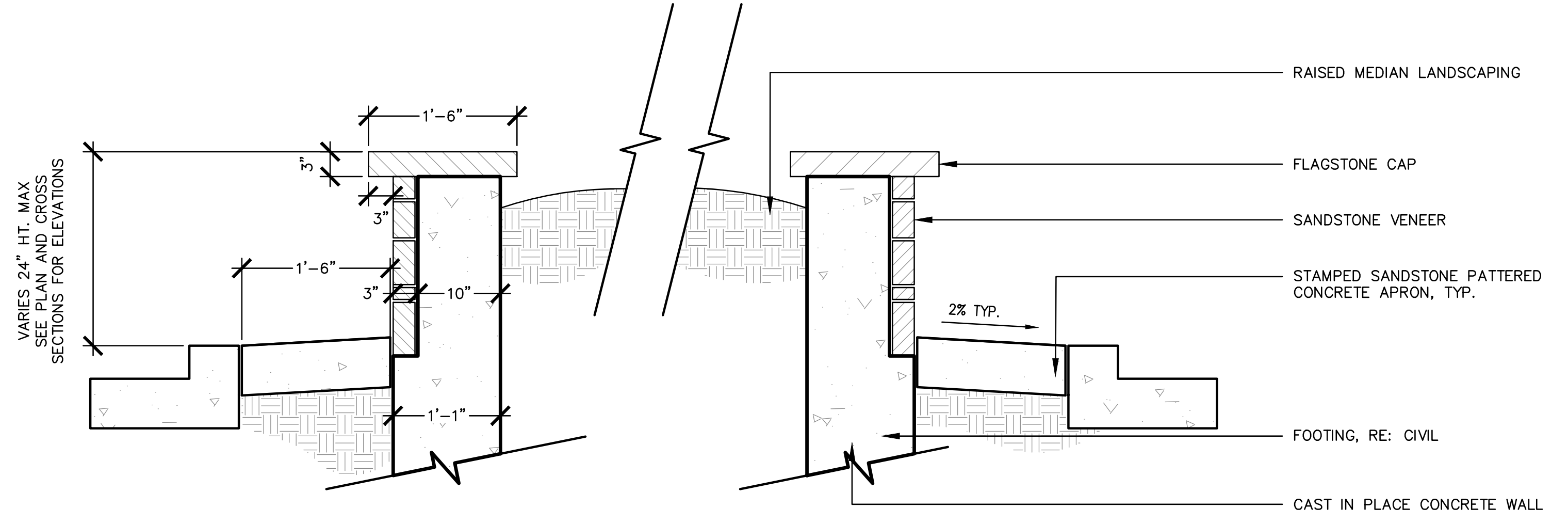

2 MID MEDIAN WALL SCALE: NTS

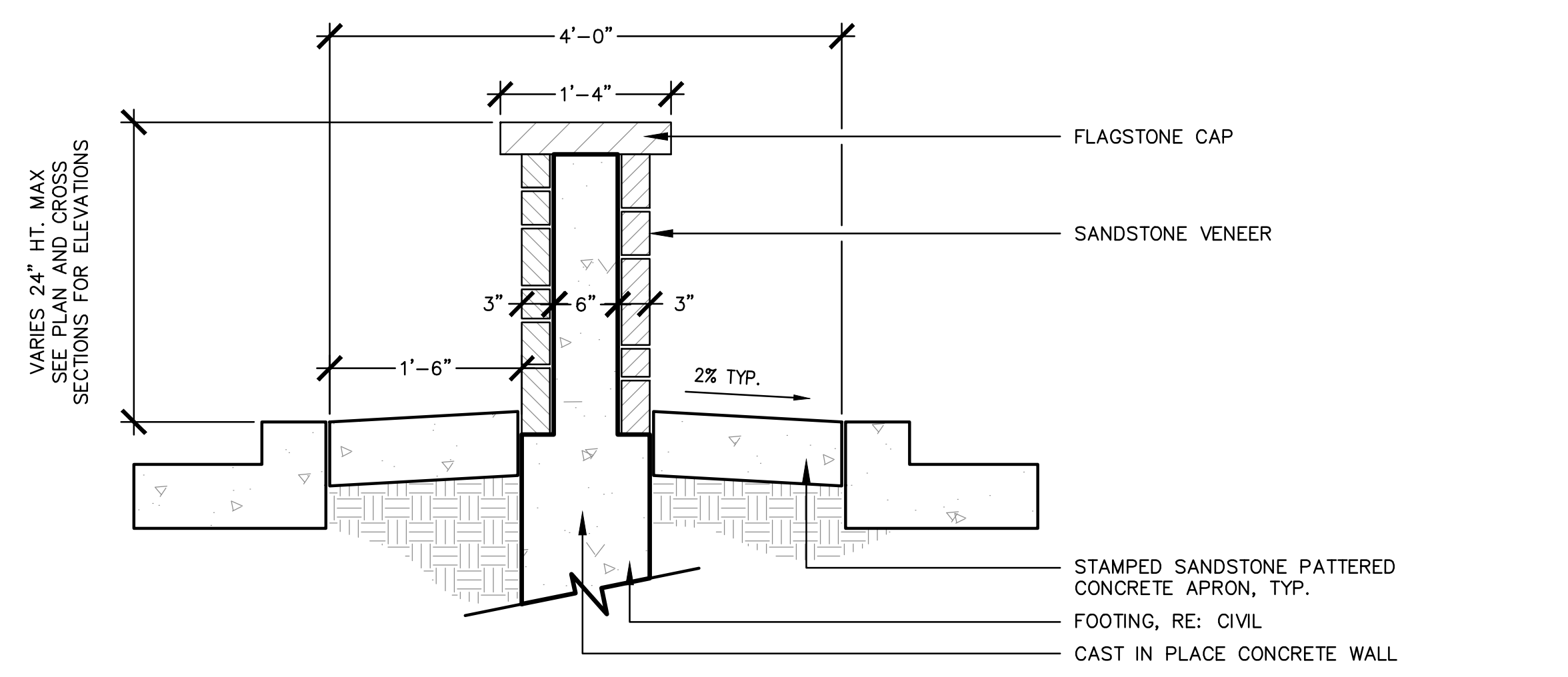

3 NORTH MEDIAN WALL SCALE: NTS

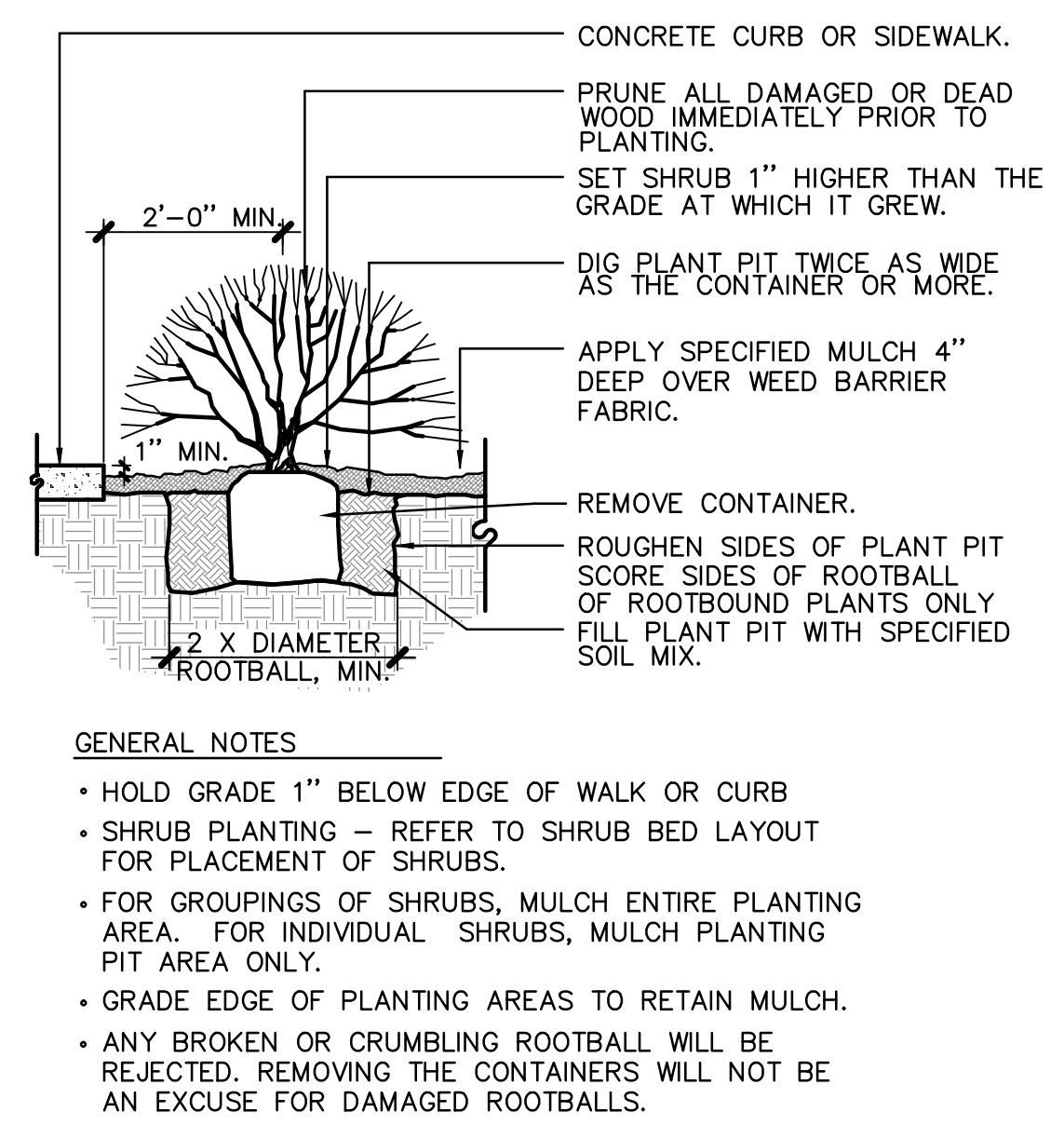

4 TYPICAL SHRUB PLANTING SCALE: NTS

PLANT LIST

Symbol	Qty.	Common Name	Botanical Name	Mn. Size
EVERGREEN SHRUBS				
	51	Buffalo Juniper	Juniperus sabina 'Buffalo'	#5 container, 18" spread min.
PERENNIALS/ ORNAMENTAL GRASSES				
46		Feather Reed Grass	Calamagrostis acutiflora 'Karl Foerster'	#1 container, well established
107		Happy Returns Daylily	Hemerocallis 'Happy Returns'	#1 container, well established
71		Red Switch Grass	Panicum virgatum	#1 container, well established
88		Dwarf Fountain Grass	Pennisetum alopecuroides 'Hameln'	#1 container, well established
29		Red Hot Poker	Kniphofia 'Stark's Early Hybrids'	#1 container, well established
40		Paprika Yarrow	Achillea millefolium 'Paprika'	#1 container, well established
25		Red Rocks Penstemon	Penstemon mexicanus 'Red Rocks'	#1 container, well established
38		Autumn Joy Sedum	Sedum 'Autumn Joy'	#1 container, well established

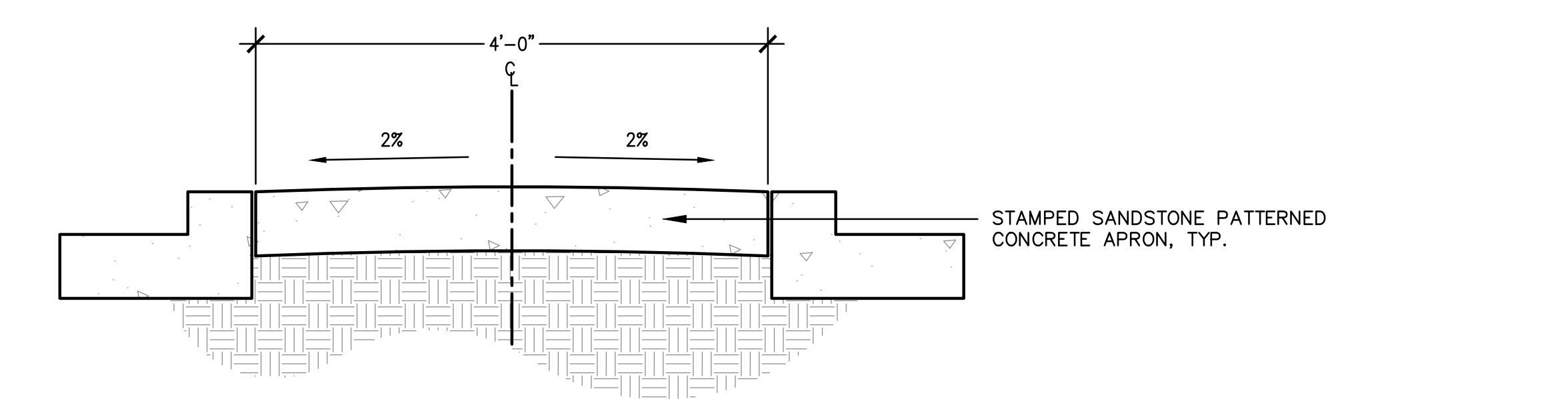

5 4'-0" WIDE MEDIAN SCALE: NTS

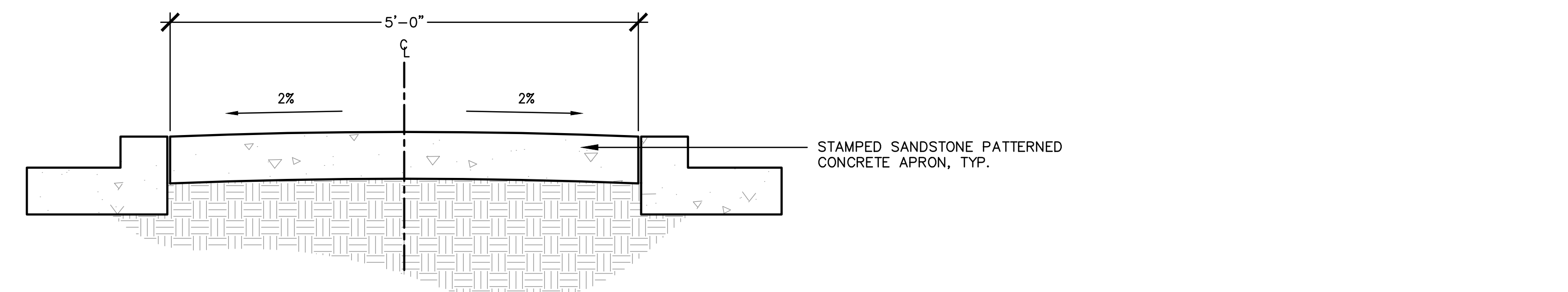

6 5'-0" WIDE MEDIAN SCALE: NTS

LANDSCAPE NOTES

- ALL PLANT MATERIAL IS TO BE APPROVED BY THE OWNER'S REPRESENTATIVE PRIOR TO INSTALLATION.
- SHRUB BED LAYOUT TO BE STAKED OUT ON THE SITE FOR APPROVAL BY THE OWNER'S REPRESENTATIVE PRIOR TO INSTALLATION. PROVIDE SHRUB BED LAYOUT BASED UPON THIS LANDSCAPE PLAN AND NOT THE IRRIGATION PLAN.
- THE CONTRACTOR SHALL FINE GRADE ALL AREAS TO BE PLANTED. THE CONTRACTOR SHALL REMOVE REQUIRED DEPTH OF SOIL ALONG CURBS AND WALKWAYS TO ACCOMMODATE SEED, SOD OR MULCH DEPTH.
- ALL AREAS TO BE PLANTED, WILL HAVE THE TOPSOIL INSTALLED. THESE AREAS WILL THEN BE TILLED TO A MINIMUM 6" DEPTH INCORPORATING A-1 ORGANICS BIOCOMP CLASS 1 COMPOST AT A MINIMUM RATE OF 4 C.Y. PER 1000 S.F. THE DISTURBED AREAS OF THE SITE WILL THEN BE FINE GRADED IN PREPARATION FOR SEEDING, SODDING OR PLANTING AS SPECIFIED IN THE PLANS AND SPECIFICATIONS.
- ALL BED AREAS WILL RECEIVE A MINIMUM OF 4" OF FIR FIBER MULCH OR APPROVED EQUAL. THE CONTRACTOR IS RESPONSIBLE FOR WEED CONTROL ON BEDS AND SEEDING AREAS UNTIL FINAL PROJECT ACCEPTANCE. TREE PLANTINGS AND PLANTING BEDS WILL BE TREATED WITH DIEHARD TRANSPANT (TREES) AND DIEHARD BED PREP (PLANTING BEDS) MICORRHIZA INOCULANTS INSTALLED AND AT THE RATE RECOMMENDED BY THE MANUFACTURER.
- ALL PLANT MATERIALS WILL CONFORM TO THE AMERICAN ASSOCIATION OF NURSERYMEN AND STATE OF COLORADO INDUSTRY STANDARDS.
- THE CONTRACTOR IS RESPONSIBLE FOR VERIFYING ALL PLANT QUANTITIES. SYMBOLS ON ALL SHRUBS AND TREES SHALL TAKE PRECEDENCE OVER WRITTEN QUANTITIES.
- THE CONTRACTOR SHALL MAINTAIN POSITIVE DRAINAGE AWAY FROM ALL STRUCTURES AND WALKWAYS. HAVE ALL FINE GRADING APPROVED PRIOR TO SEEDING.
- CONTRACTOR SHALL INSTALL SLEEVING FOR IRRIGATION IMPROVEMENTS PRIOR TO INSTALLING CONCRETE FLATWORK.
- THE CONTRACTOR SHALL BE RESPONSIBLE FOR THE REPAIR OF ANY DAMAGE TO EXISTING UTILITIES, CURB AND GUTTER, WALKWAYS, IRRIGATION SYSTEM AND OTHER EXISTING STRUCTURES THAT IS A RESULT OF HIS WORK. THE REPAIR OF SUCH DAMAGE WILL BE AT NO ADDITIONAL COST TO THE OWNER.

XREFS: DHM-TITLEBLOCK - 4408 1\X-WORKFILE\NORTHGLENN - GRANT STREET MEDIANS - 15262-00106 - CD - Design Development\Drawings\TitleBlock - 4408.dwg
 FILE NAME: C:\Users\mtw\OneDrive\Documents\15262-00106 - CD - Design Development\Drawings\TitleBlock - 4408.dwg
 PLOT DATE: 11/10/2015 10:42 AM

